







## Ordering Code

**SRC** - **T** - **03** - **20**

Series No	Type of Mounting	Valve Size	Design No
SR: Restrictor	G Subplate Mounting	03: (3/8") ISO 5781-AG-06-2-A	20 (G) DIN 912 bolts 
SRG			
SRC: One Way Restrictor	T Threaded Connection	06: (3/4") ISO 5781-AH-08-2-A	2090 (G) UNC bolts (North America) 
			
SRCG		10: (1 1/4") ISO 5781-AJ-10-2-A	20 (T) PT Connection PT 
			
			2090 (T) NPT Connection (North America) NPT 



SYMBOL

**C**

SRG

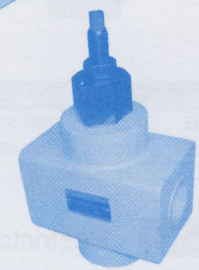
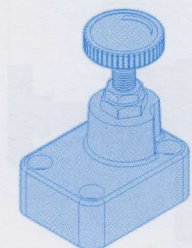

MODEL	DESCRIPTION
SRG-03-06	Restrictors(Sub-Plate Type)
SRG-10	Restrictors(Sub-Plate Type)
SRCG-03-06	One Way Restrictors(Sub-Plate Type)
SRCG-10	One Way Restrictors(Sub-Plate Type)
SRCT-03-06	One Way Restrictors(Threaded Type)
SRCT-10	One Way Restrictors(Threaded Type)

SRCG

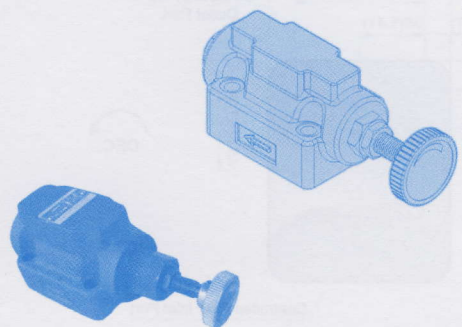

SRCT

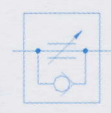
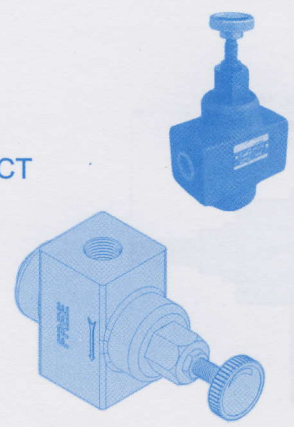

SYMBOL

**DIMENSIONS**

**MILLIMETERS(INCHES)**

**SRG-03-06 Restrictors(Sub-Plate Type)**

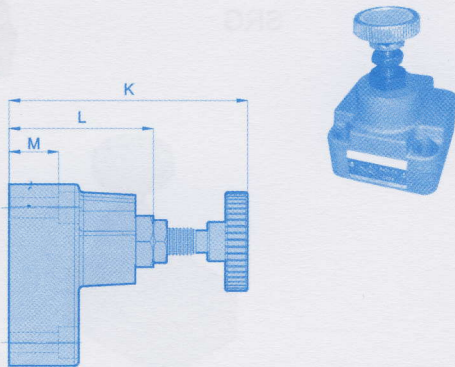
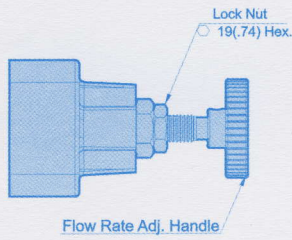

**Valve Specifications & Attachment**

Model	SRG-03	SRG-06
Flow Rating	30 lpm (7.9 gpm)	85 lpm (22.4 gpm)
Max. Pressure	250 bar (3600 psi)	250 bar (3600 psi)
Weight kg(lbs.)	2.5 (5.5)	3.9 (8.6)
CODE:20	M10 X45LgX4pcs	M10X50LgX4pcs
CODE:2090	3/8-16UNCX1-3/4LgX4pcs	3/8-16UNCX2LgX4pcs
Surface O-Ring	P18X2pc	P29X2pc
ISO Mounting	5781-AG-06-2-A	5781-AH-08-2-A

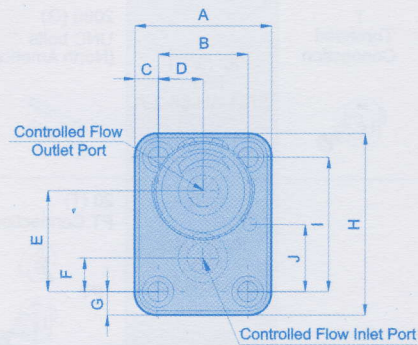

Model	A	B	C	D	E	F	G	H	I	J	K	L	M
SRG-03	61(2.40)	40(1.57)	10.5(.41)	20(.78)	45(1.77)	15(.59)	10.5(.41)	81(3.18)	60(2.36)	30(1.18)	106(4.17)	64(2.51)	22(.86)
SRG-06	81(3.18)	58(2.28)	11.5(.45)	29(1.14)	54(2.12)	16(.62)	11.5(.45)	93(3.66)	70(2.75)	35(1.37)	125(4.92)	69(2.71)	32.5(1.27)

**SRG-10 Restrictors(Sub-Plate Type)**

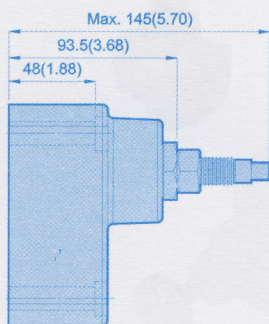
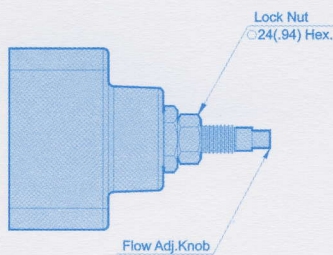

**Valve Specifications & Attachment**

Model	SRG-10
Flow Rating	230 lpm (60.7 gpm)
Max. Pressure	250 bar (3600 psi)
Weight kg(lbs.)	7.5 (16.5)
CODE:20	M10 X55LgX8pcs
CODE:2090	3/8-16UNCX2-1/4LgX6pcs
Surface O-Ring	P38X2pc
ISO Mounting	5781-AJ-10-2-A

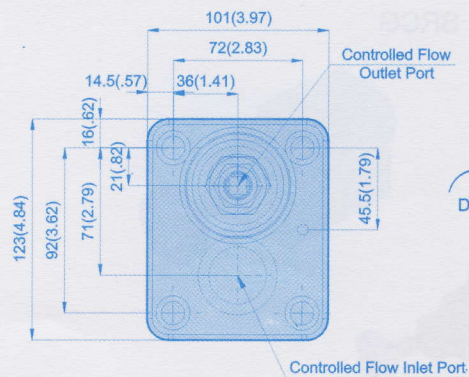



## DIMENSIONS

## MILLIMETERS(INCHES)

### SRCG-03-06 One Way Restrictors(Sub-Plate Type)

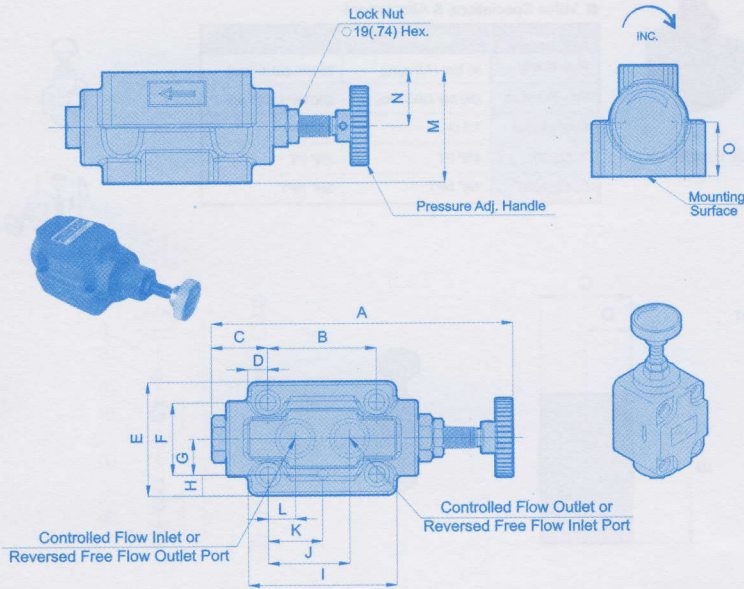

#### Valve Specifications & Attachment

Model	SRCG-03	SRCG-06
Flow Rating	30 lpm (7.9 gpm)	85 lpm (22.4 gpm)
Max. Pressure	250 bar (3600 psi)	250 bar (3600 psi)
Weight kg(lbs.)	2.5 (5.5)	3.9 (8.6)
CODE:20	M10 X45LgX4pcs	M10X50LgX4pcs
CODE:2090	3/8-16UNCX1-3/4LgX4pcs	3/8-16UNCX2LgX4pcs
Surface O-Ring	P18X2pc	P29X2pc
ISO Mounting	5781-AG-06-2-A	5781-AH-08-2-A



SYMBOL

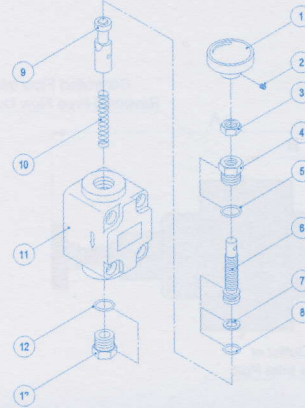

Model	A	B	C	D	E	F	G	H	I	J	K	L	M	N	O
SRCG-03	167(6.57)	60(2.36)	31(1.22)	11(.43)	63(2.48)	40(1.57)	20(.78)	11.5(.45)	82(3.22)	45(1.77)	30(1.18)	15(.59)	62(2.44)	30.5(1.20)	30(1.18)
SRCG-06	198(7.79)	70(2.75)	30.5(1.20)	10.5(.41)	80(3.14)	58(2.28)	29(1.14)	11(.43)	91(3.58)	54(2.12)	35(1.37)	16(.62)	74(2.91)	30(1.18)	30(1.18)

### SRCG-10 One Way Restrictors(Sub-Plate Type)

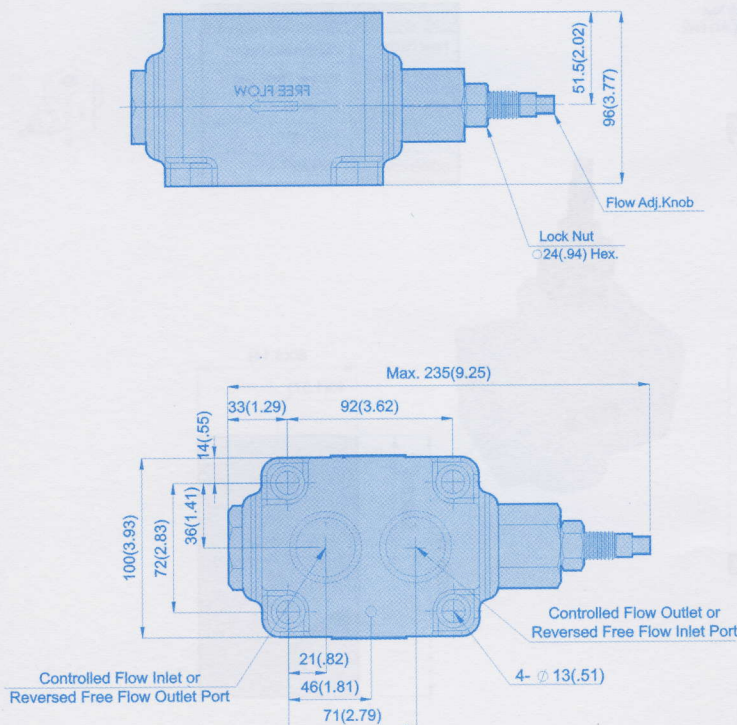

#### Valve Specifications & Attachment

Model	SRCG-10
Flow Rating	230 lpm (60.7 gpm)
Max. Pressure	250 bar (3600 psi)
Weight kg(lbs.)	7.5 (16.5)
CODE:20	M10 X55LgX6pcs
CODE:2090	3/8-16UNCX2-1/4LgX6pcs
Surface O-Ring	P34X2pc
ISO Mounting	5781-AJ-10-2-A



SYMBOL

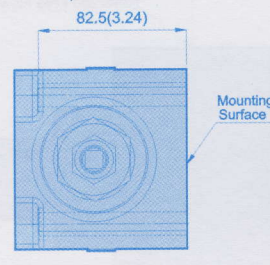

**SRCT-03-06 One Way Restrictors(Threaded Type)**

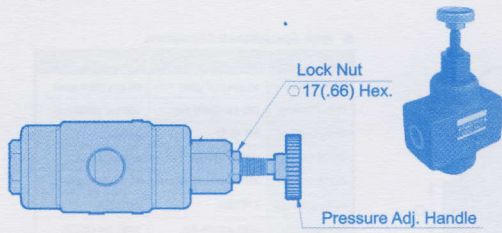

■ Valve Specifications & Attachment

Model	SRCT-03	SRCT-06
Flow Rating	30 lpm (7.9 gpm)	85 lpm (22.4 gpm)
Max. Pressure	250 bar (3600 psi)	250 bar (3600 psi)
Weight kg(lbs.)	1.5 (3.3)	3.8 (8.4)
CODE:20	3/8" PT	3/4" PT
CODE:2090	3/8" NPT	3/4" NPT



SYMBOL

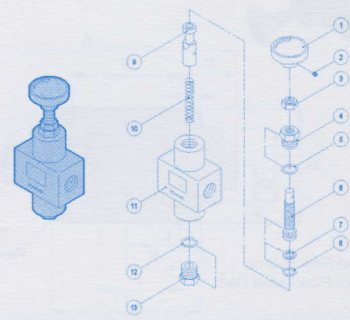
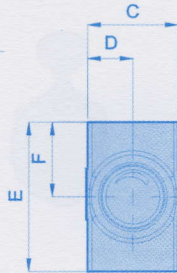
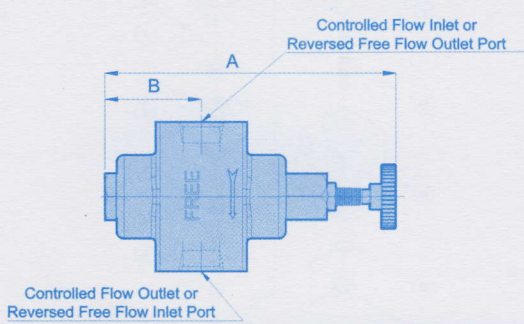

Model	A	B	C	D	E	F
SRT-03	125(4.92)	25(.98)	43(1.69)	21.5(.84)	72(2.83)	36(1.41)
SRCT-06	167(6.57)	61(2.40)	43(1.69)	21.5(.84)	72(2.83)	36(1.41)
SRCT-10	198(7.79)	65.5(2.57)	62(2.44)	31(1.22)	102(4.01)	51(2.00)

**SRCT-10 One Way Restrictors(Threaded Type)**

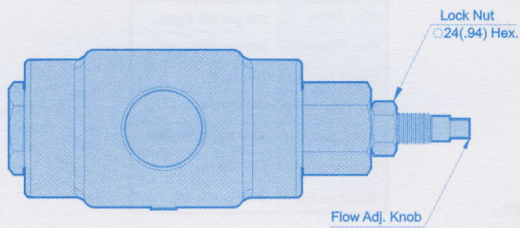

■ Valve Specifications & Attachment

Model	SRCT-10
Flow Rating	230 lpm (60.7 gpm)
Max. Pressure	250 bar (3600 psi)
Weight kg(lbs.)	9.1 (20.1)
CODE:20	1 1/4 PT
CODE:2090	1 1/4 NPT



SYMBOL

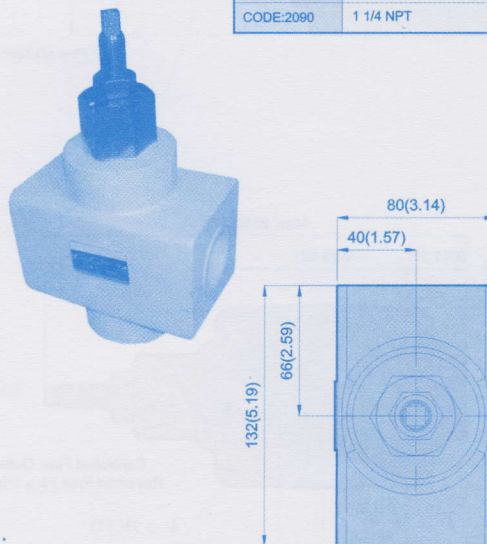
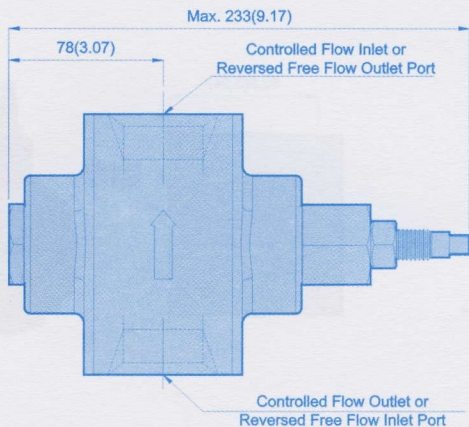











## Ordering Code

**CL - T - 06 - C - 20**



SYMBOL

**C**

Series No	Type of Mounting	Valve Size	Spool Type	Design No
CL: Cam Operated Directional Valves	G Subplate Mounting 	03: (3/8") ISO ***	None: Normally Open Type	20 (G) DIN 912 bolts 
CLT: 	T Threaded Connection 	06: (3/4") ISO ***	C: Normally Closed Type	2090 (G) UNC bolts (North America) 
CLG: 		10: (1 1/4") ISO ***		20 (T) PT Connection 
				2090 (T) NPT Connection (North America) 

CLT

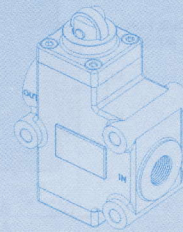

MODEL	DESCRIPTION
CLT-03-06	Deceleration with Check Valves(Threaded Type)
CLG-06	Deceleration with Check Valves(Sub-Plate Type)

CLT

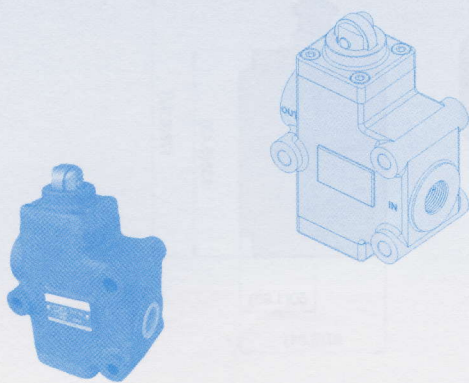

CLG

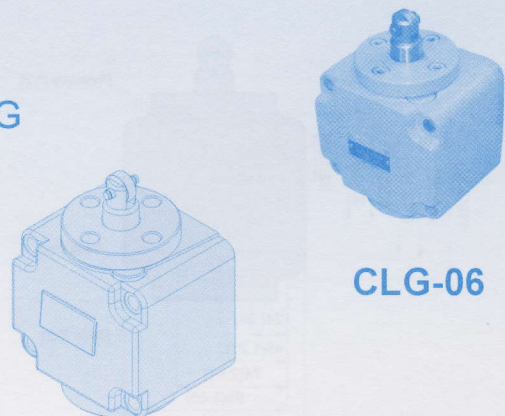

CLG-06

**CLT-03-06** Deceleration with Check Valves(Threaded Type)

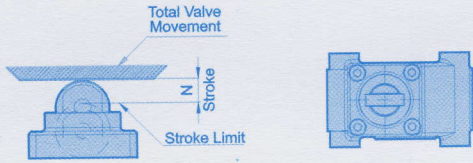

■ Valve Specifications & Attachment

Model	CLT-03	CLT-06
Flow Rating	30 lpm (7.92 gpm)	85 lpm (22.4 gpm)
Max. Pressure	140 bar (2000 psi)	140 bar (2000 psi)
Weight kg(lbs.)	5 (11.0)	5 (11.0)
CODE:20	3/8" PT	3/4" PT
CODE:2090	3/8" NPT	3/4" NPT



SYMBOL

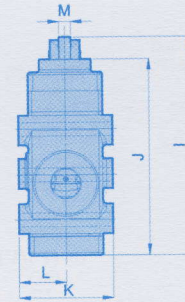
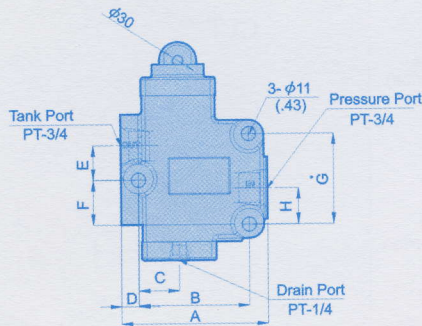

Model	A	B	C	D	E	F	G	H	I	J	K	L	M	N	O
CLT-03	116(4.56)	84(3.30)	31(1.22)	16(.62)	34(1.33)	16(.62)	68(2.67)	26(1.02)	161(6.33)	144.5(5.68)	68(2.67)	34(1.33)	8(.31)	27(1.06)	12(.47)
CLT-06	118(4.64)	90(3.54)	33(1.29)	13.5(.53)	28(1.10)	35(1.37)	73(2.87)	29(1.14)	176.5(6.94)	158.5(6.24)	76(2.99)	38(1.49)	9.5(.37)	30(1.18)	12(.47)

**CLG-06** Deceleration with Check Valves(Sub-Plate Type)

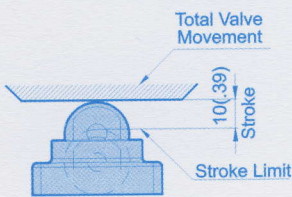

■ Valve Specifications & Attachment

Model	CLG-06
Flow Rating	85 lpm (22.4 gpm)
Max. Pressure	250 bar (3600 psi)
Weight kg(lbs.)	9 (19.8)
CODE:20	M10X100LgX4pcs
CODE:2090	3/8-16UNCX4LgX4pcs
Surface O-Ring	P28X2pc





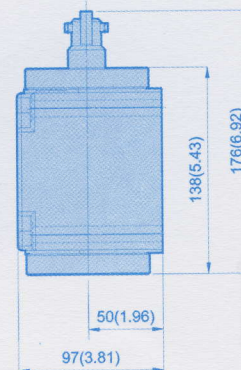
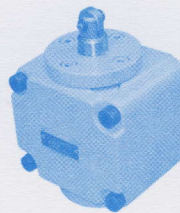
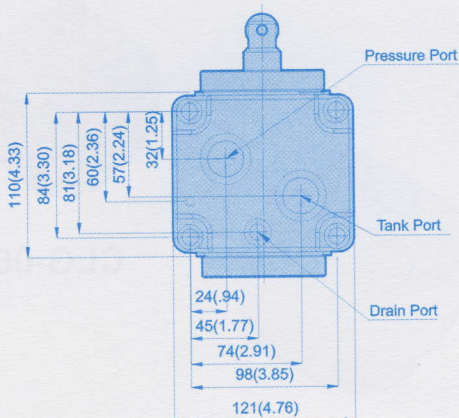











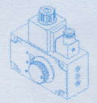

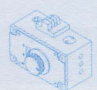



SYMBOL







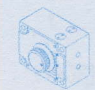





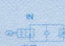

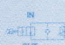







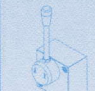

# FLOW CONTROL VALVES



FLOW CONTROL WITH CHECK VALVES (AXIAL CAM OPERATED)	Graphic Symbol	Q max. lpm (USgpm)	Rate Flow lpm	P max. bar(PSI)	Ref. Page
 HF-TGM-001-03 HF-TGM-002-03 HF-TGM-004-03		30 (7.9)	0.1-1	70 (1000)	
			0.1-2		
			0.1-4		
<b>FLOW CONTROL WITH CHECK VALVES (AXIAL CAM OPERATED) DUAL FEED</b>	Graphic Symbol	Q max. lpm (USgpm)	Rate Flow lpm	P max. bar(PSI)	Ref. Page
 HF-ZGMD-2-1-03 HF-ZGMD-4-1-03 HF-ZGMD-4-2-03 HF-ZGMD-8-4-03		30 (7.9)	0.1-2 0.1-1	70 (1000)	
			0.1-4 0.1-1		
			0.1-4 0.1-2		
			0.1-8 0.1-4		
<b>SOLCON VALVES (PRESSURE COMPENSATED)</b>	Graphic Symbol	Q max. lpm (USgpm)	Rate Flow lpm	P max. bar(PSI)	Ref. Page
 MFS-GO-02-03 MFS-GO-04-03 MFS-GO-08-03 MFS-GO-12-03		30 (7.9)	0.1-2	70 (1000)	
			0.1-4		
			0.1-8		
			0.1-12		
<b>SOLCON VALVES (PRESSURE COMPENSATED)</b>	Graphic Symbol	Q max. lpm (USgpm)	Rate Flow lpm	P max. bar(PSI)	Ref. Page
 FPR-MGKS-002-03 FPR-MGKS-004-03 FPR-MGKS-008-03 FPR-MGKS-012-03		30 (7.9)	0.1-2	70 (1000)	
			0.1-4		
			0.1-8		
			0.1-12		
<b>FLOW CONTROL WITH CHECK VALVES (AXIAL CAM OPERATED)</b>	Graphic Symbol	Q max. lpm (USgpm)	Rate Flow lpm	P max. bar(PSI)	Ref. Page
 FPR-MGK-002-03 FPR-MGK-004-03 FPR-MGK-008-03		30 (7.9)	0.1-2	70 (1000)	
			0.1-4		
			0.1-8		

FLOW CONTROL WITH CHECK VALVES (ROTOR OPERATED)	Graphic Symbol	Q max. lpm (USgpm)	Rate Flow lpm	P max. bar(PSI)	Ref. Page
 FPR-MGK-002-03A FPR-MGK-004-03A FPR-MGK-008-03A		30 (7.9)	0.1-2	70 (1000)	
			0.1-4		
			0.1-8		
<b>FLOW CONTROL WITH CHECK VALVES</b>	Graphic Symbol	Q max. lpm (USgpm)	Rate Flow lpm	P max. bar(PSI)	Ref. Page
 FPR-MGK-002-03B FPR-MGK-004-03B FPR-MGK-008-03B		30 (7.9)	0.1-2	70 (1000)	
			0.1-4		
			0.1-8		
<b>FLOW CONTROL WITH CHECK VALVES (ROTOR OPERATED)</b>	Graphic Symbol	Q max. lpm (USgpm)	Rate Flow lpm	P max. bar(PSI)	Ref. Page
 FKC-G-002-03A FKC-G-004-03A FKC-G-008-03A		30 (7.9)	0.1-2	70 (1000)	
			0.1-4		
			0.1-8		
<b>FLOW CONTROL WITH CHECK VALVES (ROTOR OPERATED)</b>	Graphic Symbol	Q max. lpm (USgpm)	Rate Flow lpm	P max. bar(PSI)	Ref. Page
 FKC-G03-002-AL FKC-G03-004-AL FKC-G03-008-AL		30 (7.9)	0.1-2	70 (1000)	
			0.1-4		
			0.1-8		
<b>FLOW CONTROL WITH CHECK VALVES</b>	Graphic Symbol	Q max. lpm (USgpm)	Rate Flow lpm	P max. bar(PSI)	Ref. Page
 FKC-G-002-03B FKC-G-004-03B FKC-G-008-03B		30 (7.9)	0.1-2	70 (1000)	
			0.1-4		
			0.1-8		

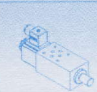
FLOW CONTROL WITH CHECK VALVES (AXIAL CAM OPERATED)	Graphic Symbol	Q max. lpm (USgpm)	Rate Flow lpm	P max. bar(PSI)	Ref. Page
 FKC-G-02001-02 FKC-G-02002-02 FKC-G-02004-02		20 (5.2)	0.1-1	70 (1000)	
			0.1-2		
			0.1-4		
<b>FLOW CONTROL WITH CHECK VALVES (ROTOR OPERATED)</b>	Graphic Symbol	Q max. lpm (USgpm)	Rate Flow lpm	P max. bar(PSI)	Ref. Page
 FKC-G-02001-02A(L) FKC-G-02002-02A(L) FKC-G-02004-02A(L)		20 (5.2)	0.1-1	70 (1000)	
			0.1-2		
			0.1-4		
<b>FLOW CONTROL WITH CHECK VALVES (ROTOR OPERATED)</b>	Graphic Symbol	Q max. lpm (USgpm)	Rate Flow lpm	P max. bar(PSI)	Ref. Page
 FKC-G-02001-02LA FKC-G-02002-02LA FKC-G-02004-02LA		20 (5.2)	0.1-1	70 (1000)	
			0.1-2		
			0.1-4		
<b>FLOW CONTROL WITH CHECK VALVES</b>	Graphic Symbol	Q max. lpm (USgpm)	Rate Flow lpm	P max. bar(PSI)	Ref. Page
 FKC-G02-001-02B FKC-G02-002-02B FKC-G02-004-02B		20 (5.2)	0.1-1	70 (1000)	
			0.1-2		
			0.1-4		
<b>FLOW CONTROL WITH CHECK VALVES(DUAL FEED)</b>	Graphic Symbol	Q max. lpm (USgpm)	Rate Flow lpm	P max. bar(PSI)	Ref. Page
 FKC-G02-001-02B2 FKC-G02-002-02B2 FKC-G02-004-02B2		20 (5.2)	0.1-1	70 (1000)	
			0.1-2		
			0.1-4		

DECLARATION FLOW CONTROL WITH CHECK VALVES (MANUALLY OPERATED)	Graphic Symbol	Q max. lpm (USgpm)	Rate Flow lpm	P max. bar(PSI)	Ref. Page
 DDFC-03A(L)		30 (7.9)	—	70 (1000)	
<b>PILOT OPERATED WITH CHECK VALVES (CAM OPERATED)</b>	Graphic Symbol	Q max. lpm (USgpm)	Rate Flow lpm	P max. bar(PSI)	Ref. Page
 HK2-Y2-02		30 (7.9)	—	70 (1000)	
<b>DIRECTIONAL CONTROL VALVES (MANUALLY OPERATED)</b>	Graphic Symbol	Q max. lpm (USgpm)	Rate Flow lpm	P max. bar(PSI)	Ref. Page
 HV-02-G		20 (5.2)	—	70 (1000)	
<b>DIRECTIONAL CONTROL VALVES (MANUALLY OPERATED)</b>	Graphic Symbol	Q max. lpm (USgpm)	Rate Flow lpm	P max. bar(PSI)	Ref. Page
 HV-03		30 (7.9)	—	70 (1000)	
<b>FLOW CONTROL WITH CHECK VALVES</b>	Graphic Symbol	Q max. lpm (USgpm)	Rate Flow lpm	P max. bar(PSI)	Ref. Page
 FKCS-03-S2		30 (7.9)	0.1-1	70 (1000)	
			0.1-2		
			0.1-4		

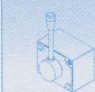
FLOW CONTROL WITH CHECK VALVES(DUAL FEED)	Graphic Symbol	Q max. lpm (USgpm)	Rate Flow lpm	P max. bar(PSI)	Ref. Page
 FM-GO-02 FM-GO-04 FM-GO-08		20 (5.2)	0.1-1	70 (1000)	
			0.1-4		
			0.1-8		

MANUALLY OPERATED DIRECTIONAL VALVES	Graphic Symbol	Q max. lpm (USgpm)	Rate Flow lpm	P max. bar(PSI)	Ref. Page
 HV-03QT		30 (7.9)	0.1-1	70 (1000)	
			0.1-2		
			0.1-4		

**DIMENSIONS**

**MILLIMETERS(INCHES)**

**FPR-MGK-00\*-03B**

Flow Control with Check Valves  
Pressure Compensated (Sub-plate Type)



SYMBOL

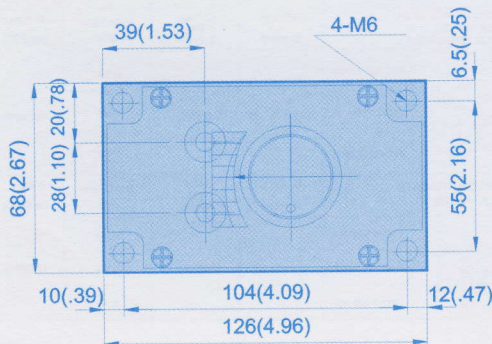
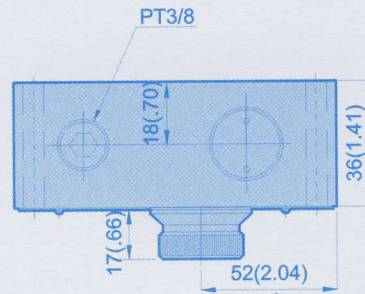
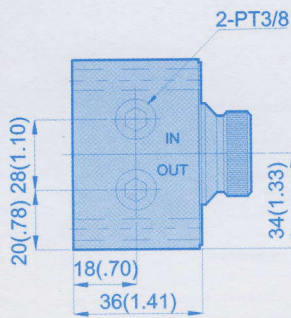
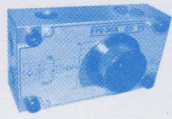

Valve Specifications & Attachment

Model	FPR-MGK-00*-03B
Free Flow	30 lpm (7.9 gpm)
Max. Pressure	70 bar (1000 psi)
Weight kg(lbs.)	2.16 (4.75)
CODE:20	M6 X45LgX4pcs
Surface O-Ring	P16X2pc

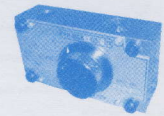

Model	Within Flow Rate Adjusting (lpm)	Connection Bore
FPR-MGK-002-03B	0.1 - 2	PT 3/8
FPR-MGK-004-03B	0.1 - 4	
FPR-MGK-008-03B	0.1 - 8	

**FKC-G-00\*-03A**

Flow Control with Check Valves (Rotary Operated)  
Pressure Compensated (Sub-plate Type)



SYMBOL

Sub-plate Dimensions

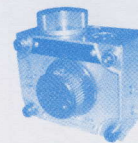
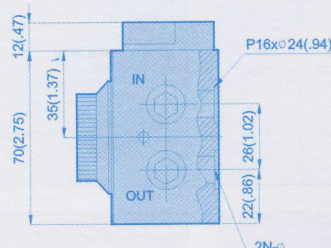
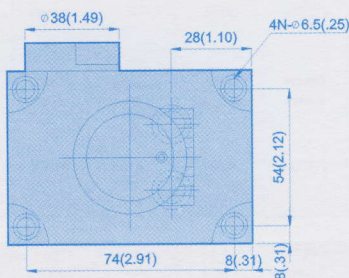
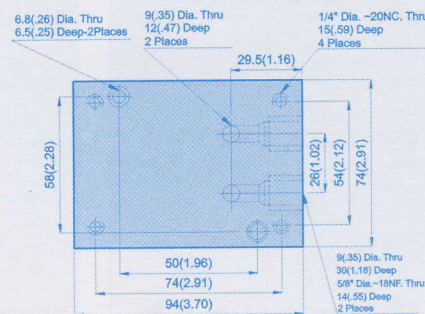
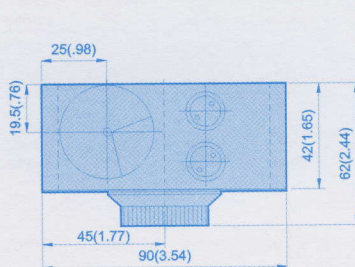

Valve Specifications & Attachment

Model	FKC-G-00*-03A
Free Flow	30 lpm (7.9 gpm)
Max. Pressure	70 bar (1000 psi)
Weight kg(lbs.)	1.96 (4.31)
CODE:20	M6 X45LgX4pcs
Surface O-Ring	P12X2pcs

Model	Within Flow Rate Adjusting (lpm)	Connection Bore
FKC-G-002-03A	0.1 - 2	PT 3/8
FKC-G-004-03A	0.1 - 4	
FKC-G-008-03A	0.1 - 8	





## DIMENSIONS

MILLIMETERS(INCHES)

### FKC-G03-\*\*\*-AL

Flow Control with Check Valves (Rotary Operated)  
Pressure Compensated (Sub-plate Type)

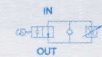

SYMBOL

#### Sub-plate Dimensions

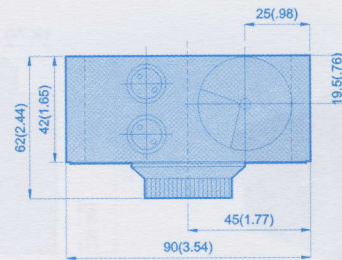
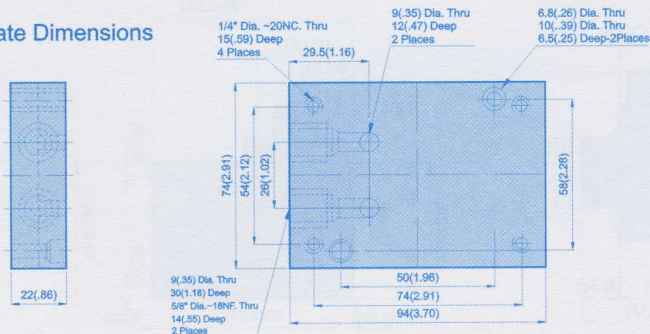

### FKC-G03-\*\*-AL

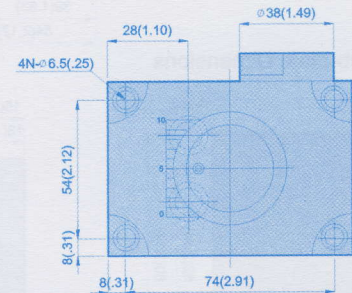

### FKC-G03-\*\*-AR

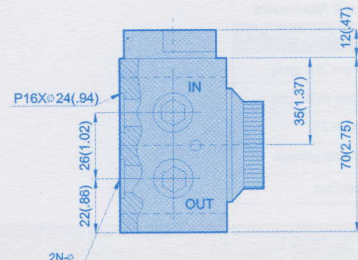

### FKC-G03-\*\*-AR

#### Valve Specifications & Attachment

Model	FKG-G 03-03AL
Free Flow	30 lpm (7.9 gpm)
Max. Pressure	70 bar (1000 psi)
Weight kg(lbs.)	1.96 (4.31)
CODE:20	M6 X45LgX4pcs
Surface O-Ring	P12X2pcs

Model	Within Flow Rate Adjusting (lpm)	Connection Bore
FKC-G03-002-AL	0.1 - 2	PT 3/8
FKC-G03-004-AL	0.1 - 4	
FKC-G03-006-AL	0.1 - 6	

### FKC-G03-\*\*\*B(L)

Flow Control with Check Valves  
Pressure Compensated (Sub-plate Type)



SYMBOL

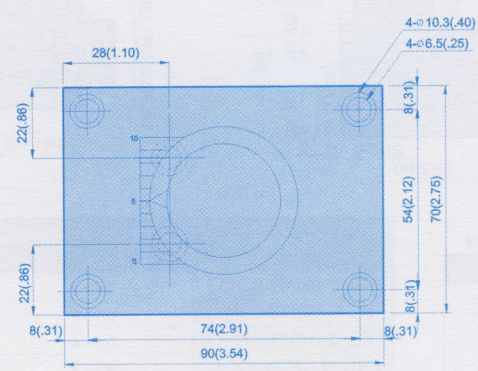
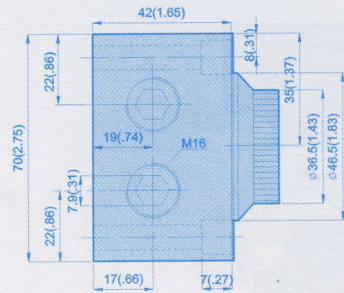
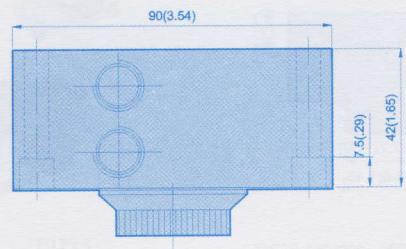

#### Valve Specifications & Attachment

Model	FKG-G 03-03B
Free Flow	30 lpm (7.9 gpm)
Max. Pressure	70 bar (1000 psi)
Weight kg(lbs.)	1.90 (4.18)
CODE:20	M6 X45LgX4pcs
Surface O-Ring	P12X2pcs

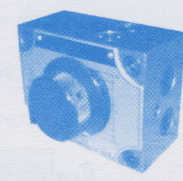

Model	Within Flow Rate Adjusting (lpm)	Connection Bore
FKC-G-002-03B	0.1 - 2	PT 3/8
FKC-G-004-03B	0.1 - 4	
FKC-G-006-03B	0.1 - 6	

DIMENSIONS

MILLIMETERS(INCHES)

FKC-G02-\*\*\*

Flow Control with Check Valves (Axial Cam Operated, Push-Down)  
Pressure Compensated (Sub-plate Type)



SYMBOL

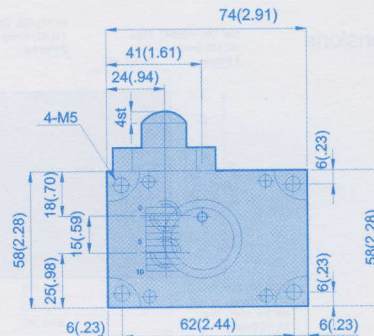
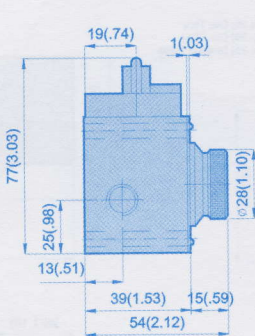
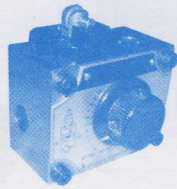

Sub-plate Dimensions

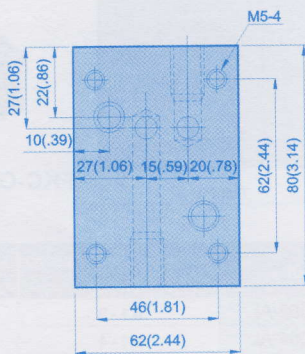

Valve Specifications & Attachment

Model	FKC-G02-***
Free Flow	20 lpm (5.2 gpm)
Max. Pressure	70 bar (1000 psi)
Weight kg(lbs.)	1.96 (4.31)
CODE:20	M6 X45LgX4pcs
Surface O-Ring	P12X2pcs

Model	Within Flow Rate Adjusting (lpm)	Connection Bore
FKC-G02-001-02	0.1 - 1	PT 1/4
FKC-G02-002-02	0.1 - 2	
FKC-G02-004-02	0.1 - 4	

FKC-G02-\*\*\*-02A\*

Flow Control with Check Valves (Rotary Operated)  
Pressure Compensated (Sub-plate Type)



SYMBOL



02A(R)  
02AL

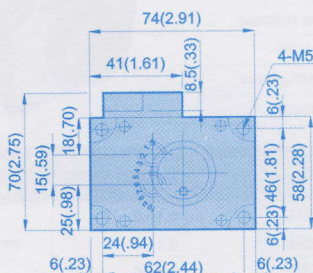
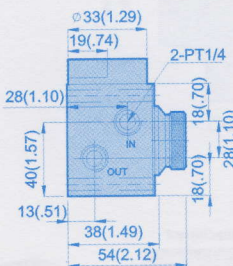
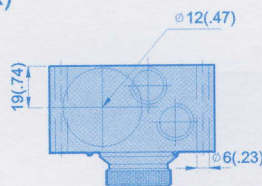

02LA  
02LAR

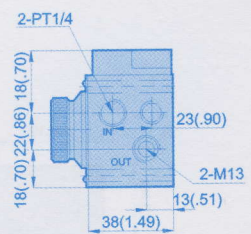
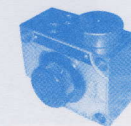
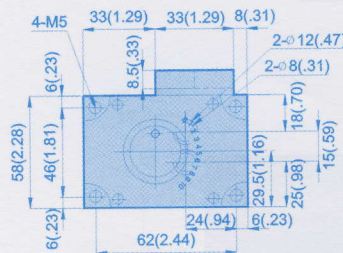
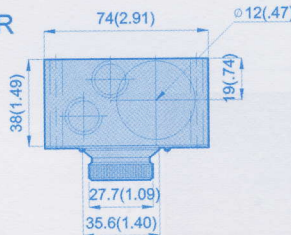

Valve Specifications & Attachment

Model	FKC-G02-***-02A*
Free Flow	20 lpm (5.29 gpm)
Max. Pressure	70 bar (1000 psi)
Weight kg(lbs.)	2.40 (5.28)
CODE:20	M5 X45LgX4pcs
Surface O-Ring	P10X2pcs

Model	Within Flow Rate Adjusting (lpm)	Connection Bore
FKC-G-02001-02A(L)	0.1 - 1	PT 1/4
FKC-G-02002-02A(L)	0.1 - 2	
FKC-G-02004-02A(L)	0.1 - 4	
FKC-G-02001-02LA	0.1 - 1	PT 1/4
FKC-G-02002-02LA	0.1 - 2	
FKC-G-02004-02LA	0.1 - 4	



## DIMENSIONS

MILLIMETERS(INCHES)

### FKC-G02-\*\*\*-02B

Flow Control with Check Valves ( Single Stage)  
Pressure Compensated (Sub-plate Type)



SYMBOL

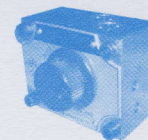
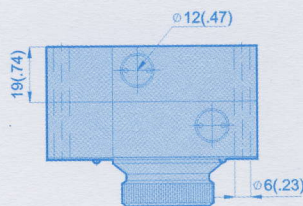
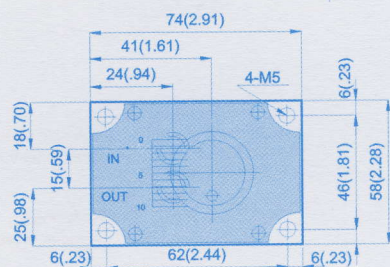

#### Sub-plate Dimensions

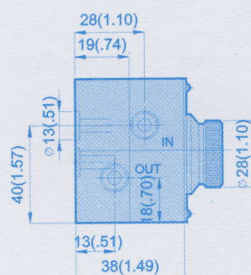
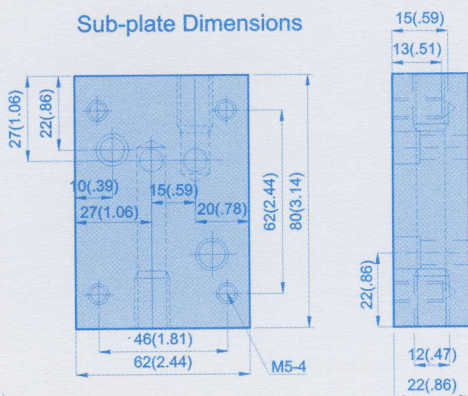

#### Valve Specifications & Attachment

Model	FKC-G02-***-02B
Free Flow	20 lpm (5.2 gpm)
Max. Pressure	70 bar (1000 psi)
Weight kg(lbs.)	2.30 (5.06)
CODE:20	M5 X45LgX4pcs
Surface O-Ring	P10X2pcs

Model	Within Flow Rate Adjusting (lpm)	Connection Bore
FKC-G02-001-02B	0.1 - 1	PT 1/4
FKC-G02-002-02B	0.1 - 2	
FKC-G02-004-02B	0.1 - 4	

### FKC-G02-\*\*\*-02B2

Flow Control with Check Valves(Two Stage)  
Pressure Compensated (Sub-plate Type)



SYMBOL

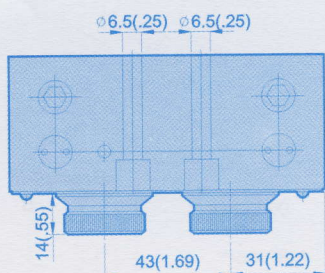

#### Valve Specifications & Attachment

Model	FKC-G02-***-02B2
Free Flow	20 lpm (5.2 gpm)
Max. Pressure	70 bar (1000 psi)
Weight kg(lbs.)	1.32 (2.90)
CODE:20	M6 X45LgX2pcs
Surface O-Ring	P10X4pcs

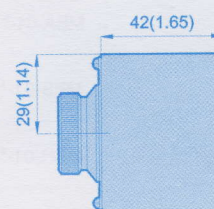
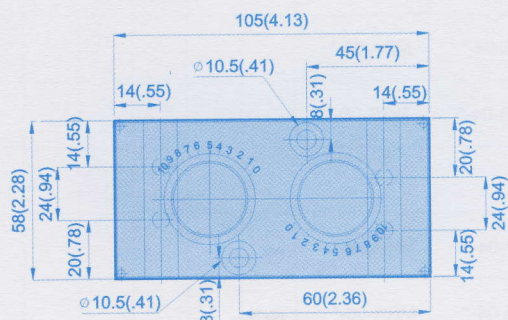

Model	Within Flow Rate Adjusting (lpm)	Connection Bore
FKC-G02-001-02B2	0.1 - 1	PT 1/4
FKC-G02-002-02B2	0.1 - 2	
FKC-G02-004-02B2	0.1 - 4	